

# CANAVIEW

Intraoral Camera

Instruction for Use



**Beyes**<sup>®</sup>  
*The Next Standard*

## Table of Contents

1. Introduction to Canaview .....	3
2. Software Setup .....	4
3. Hardware Setup.....	4
4. Cleaning and Disinfecting.....	5
5 Warranty Statement.....	7

## Safety Issues

### Check Canaview before Using It

Before each usage, check the outer surface of the Canaview for any signs of physical damage or defect. The surface of the Canaview should have a smooth finish, with no evidence of chipping or damage to either the handpiece housing or the lens section. To help ensure proper hygiene and to protect against infectious disease, refer to "Section 4.1" of this document and observe all device cleaning and patient protection recommendations specified there.

### Avoid Excessive Temperatures when Using Canaview

When in use, the LEDs in the Canaview may generate surface temperatures in excess of 106° F. (41° C). To avoid the potential risk of burn, do not use the Canaview in a single hand-held position for a prolonged period.

### Operate the Canaview as Directed

Always use the Canaview in accordance with the directions and recommendations contained in this User Guide. Do not attempt to modify the Canaview or use it in system configurations not specified in this document.



### RF Interference Considerations

Although the Canaview equipment is designed to provide a reasonable degree of protection from electromagnetic interference, according to IEC International regulations, it must be installed at an adequate distance from electricity transformer rooms, static continuity units, two-way amateur radios and cellular phones. To ensure proper operation, the latter can be used only at a minimum distance of 5 feet (1.5m) from any part of the equipment.

Any instrumentation or equipment for professional use located near Canaview must conform to Electromagnetic Compatibility regulations. Non-conforming equipment, with known poor immunity to electromagnetic fields, may not operate properly unless they are installed at a distance of at least 10 feet (3m) and supplied by a dedicated electric line.

### Explanation of Symbols on the Canaview

Some of the symbols on the Canaview identify it as having met the requirements for sale within the United States and for export internationally. The "CE" and "ETL" symbols are examples of these types of marks. The remaining symbols provide either technical or directive information.

Symbol	Description
	Indicates that the Canaview is Type BF equipment.
	Indicates an attention to users to consult accompanying documents (this User Guide) for more information on the Canaview.
	Indicates that under certain ambient environmental conditions (especially low humidity), the Canaview may be susceptible to electrostatic discharge (ESD). Appropriate care and handling must be observed to avoid damage.

## 1. Introduction to Canaview

### 1.1. Package Contents

The Canaview system hardware consists of the following components.

- Camera
- Holder
- USB Cable
- Disposable Sheaths (50 pieces)

### 1.2. Computer System Requirements

Getting the best results from your Canaview begins with having a computer system suitable for displaying and capturing video images. For optimum performance we recommend:

- 2 Ghz Pentium 4 processor
- 1 GB of RAM minimum 2 GB or above recommended
- USB 2.0 interface with high power port
- CD-ROM or DVD drive
- Imaging Software
- Internet connectivity recommended
- Windows XP Professional or above with a minimum of Service Pack 2

**IMPORTANT!** USB bandwidth is shared among all USB devices. Achieving optimum performance with the Canaview may not be possible if other USB devices are in use at the same time.

### 1.3. Overview Illustrations



## 2. Software Setup

**Scenario 1:** If you already have imaging software, please contact your existing imaging provider to assist you with the install.

**Scenario 2:** If you do not have imaging software, please refer to Canaview Quickvision Users Guide.

## 3. Hardware Setup

### 3.1. Connecting the Canaview to computer

The USB cable used with the camera is a 2.5 meter (3 yards) cable. The “5” plug connects to any available USB port on the computer. The “6” plug connects to the camera handpiece. It will take a few minutes for the computer to recognize the camera.

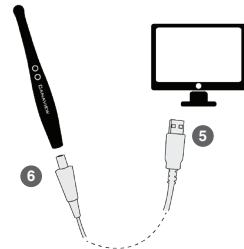

### 3.2. Installing the Canaview Handpiece Holder

The Canaview Handpiece Holder turns off the camera when the handpiece is inserted and turns on the camera when the handpiece is removed. The holder is equipped with several mounting options: (1) Can be wall-mounted with fastening hardware, or (2) Can be attached to a wall or other acceptable bonding surface with double-sided adhesive tape.



**PLEASE NOTE:** When selecting the mounting option for your Canaview, choose a location that offers easy access during patient exams and safe storage afterwards. In most practices, mounting the Canaview to the dental chair will provide the best all-around solution.

### 3.2.1. Wall-Mounting Option (with Fasteners)

To install the handpiece by fastening it to a wall or other vertical surface, do the following:

1. Remove the handpiece from its holder before performing this procedure.
2. Remove the cutout block from the handpiece holder by loosening 2 flat-head Phillips screws.
3. Position the holder on a smooth stable vertical surface. Using the holes on the back of the holder as guides, fasten the holder securely to the wall using 2 (#6 x 3/4) dry wall screws (not supplied) or other hardware appropriate to the mounting surface.

### 3.2.2. Wall-Mounting Option (with Adhesive)

To install the handpiece by attaching it with adhesive tape to a wall or other vertical surface, do the following:

1. Remove the handpiece from its holder before performing this procedure.
2. Remove the cutout block from the handpiece holder by loosening 2 flat-head Phillips screws.
3. Cut and trim a piece of double-sided adhesive tape (not supplied) to the size of the back of the holder. Remove one side of the tape and attach it to the holder.
4. When the holder is correctly located, remove the other side of the adhesive tape and fasten the holder securely to the wall or other surface.

## 4. Cleaning and Disinfecting Cameras

**IMPORTANT!** Be sure to disconnect the camera from the USB cable before performing any cleaning procedures.

The Canaview intraoral cameras use disposable sheaths to ensure proper infection control. Sheaths are intended for single-use only. Do not use the camera for intraoral use until a new sheath has been properly fitted over the handpiece. After each intra-oral use, remove the sheath and dispose of it properly.

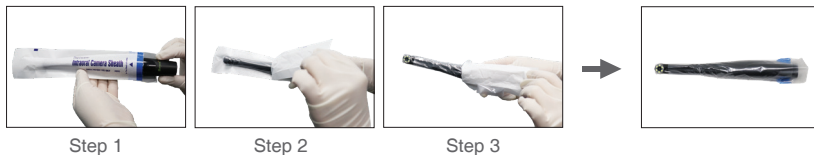

#### **4.1. Maintenances**

Health care provider should wear protective disposable gloves and cover the camera with a hygienic barrier. Camera should be disinfected and cover with a new hygienic barrier between each patient.

- Camera lens surface do not need to be regularly serviced when used with a hygienic barrier sheath.
- Regularly or excessive service to the camera lens surface will cause it to deteriorate quicker, due to exposure of chemical.

#### **4.2. Caution / Warnings**

To avoid the surface or optical system of the camera being destroyed:

- Do not spray disinfectant directly on camera. Disinfect with wipes only.
- Do not immerse camera in liquids, excessive fluids can damage the camera.
- Do not use abrasive or aggressive cleaning solution (e.g. bleach), doing so will cause plastic parts risk of deterioration.
- Do not sterilise the camera with hot air or thermo disinfectant.
- Do not sterilize camera in an autoclave.
- Do not scrub or use excessive force when disinfecting the camera.

#### **4.3. Cleaning / Disinfecting**

1. Use recommended disinfecting solution or choose a mild disinfecting solution.
2. Disconnect USB cable and make sure camera is off.
3. Dampen (do not soak) a lint-free cloth in a mild disinfecting solution. If using a disinfecting wipe; Remove excess moisture from disinfecting wipe before continuing.
4. Thoroughly wet the surface of the camera with disinfecting solution.
5. Allow camera to dry in open air.

## 5. Beyes Limited Warranty Statement

### SCOPE OF WARRANTY

BEYES Dental Canada Inc. ('BEYES') warrants to the original retail purchaser that it will be at BEYES option to repair or replace components of the dental products manufactured by BEYES (except for components not warranted under 'Exclusions') that are defective in material or workmanship under normal use and service. BEYES' obligation under this limited warranty is limited to the repair or replacement of the applicable components. This limited warranty shall only apply to defects that are reported to BEYES within the applicable warranty period and which, upon examination by Beyes, prove to be defective. This warranty extends only to the first retail purchaser of a product and is not transferable or assignable. Replacement components or products may be used and/or refurbished components or products, provided they are of like quality and specifications as new components or products.

### APPLICABLE WARRANTY PERIOD

The applicable warranty period, measured from the date of invoice to the original user, shall be warranted for a period of 12 months

### EXCLUSIONS

This limited warranty does not cover and BEYES shall not be liable for the following;

1. Defects, damage or other conditions caused, in whole or in part, by misuse, abuse, negligence, alteration, accident, freight damage, negligent storage, tampering or failure to seek and obtain repair or replacement in a timely manner;
2. Products which are not installed, used, and properly cleaned and maintained as required or recommended in the BEYES 'Installation' and/or 'Installation/User's Manual' for the applicable product, including the specified structural and operational environment conditions and electrical power requirements;
3. Products considered to be of a consumable or sterile nature;
4. Accessories or parts not manufactured by BEYES;
5. Charges by anyone for adjustments, repairs, replacement parts, installation or other work performed upon or in connection with such products which are not expressly authorized in writing in advance by BEYES;
6. Costs and expenses of routine maintenance and cleaning;
7. Representations and warranties made by any person or entity other than BEYES;

8. Matching of color, grain or texture except to commercially acceptable standards;
9. Changes in color caused by natural or artificial light;
10. Custom manufactured products;
11. Alterations or modifications to the product by any person or entity other than BEYES;
12. Products that would otherwise be covered under Sections 1 and 2 of this limited warranty, but are acquired: (i) from a person or entity that is not BEYES or one of its authorized dealers; or (ii) from a BEYES dealer that is not authorized to sell the product at issue in the geographic territory where the purchaser is located, or is not authorized to sell the product at issue within the medical, animal health or dental market, as the case may be, in which the purchaser intends to use the product.

## EXCLUSIVE REMEDY; CONSEQUENTIAL DAMAGES DISCLAIMER

Beyes' obligation under this limited warranty is the repair or replacement of defective parts. Beyes shall not be liable for and hereby disclaims any direct, special, indirect, incidental, exemplary or consequential damages or delays, including, but not limited to, damages for loss of profits or income, loss of use, downtime, cover and employee or independent contractor wages, payments and benefits.

## WARRANTY DISCLAIMER

This limited warranty is Beyes only warranty and is in lieu of all other warranties, express or implied. Beyes makes no implied warranties of any kind including any implied warranties of merchantability or fitness for a particular purpose. this warranty is limited to the repair or replacement of defective parts.



Federal law restricts this device to sale by or on the order of a dentist, physician, or any other practitioner licensed by the law of the states in which he or she practices to use or order the use of this device.

---

**Beyes Dental Canada Inc.**  
23-595 Middlefield Road  
Toronto, Ontario, M1V 3S2  
Canada  
**Tel:** 1-855-603-1888  
**Fax:** 1-855-720-1228  
**Email:** info@beyes.ca  
**Website:** www.beyes.ca



**Lotus NL B.V.**  
Koningin Juliananplein 10, le Verd,  
2595AA, The Hague,  
Netherlands  
**Tel:** +31645171879 (English)  
+31626669008 (Dutch)  
**Email:** info@beyes.ca  
**Website:** www.beyes.ca



Printed in Canada  
ENI013R3